

# Model A295

Single Point Stainless Steel Load Cell

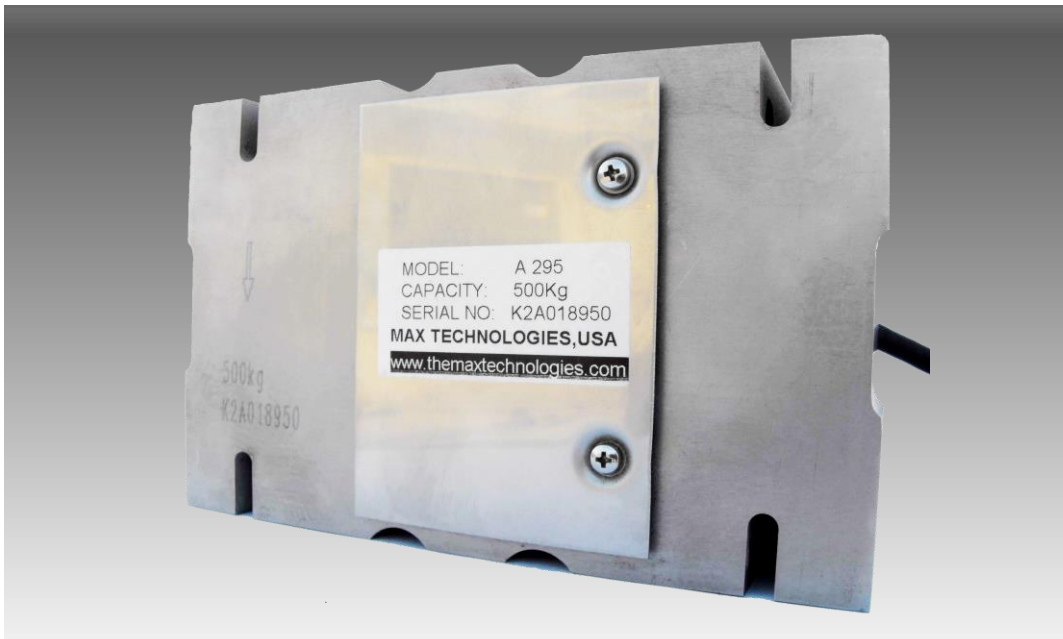

## FEATURES

- **Rated Capacities (lb):**  
100, 225, 325, 450, 550, 1000, 1500, 2000, 4500
- **Rated Capacities (kg):**  
50, 100, 150, 200, 250, 500, 750, 1000, 2000
- Stainless Steel Construction
- IP67
- Single Point Load cell
- Potted by adhesive inside, Oil Proof, Waterproof, Anti-corrosive gas.

## APPLICATIONS

- Suitable for Industrial Platform Scales, Floor Scales, Dormant Scales for Wash-down.

## TECHNICAL DATA

<b>Rated Capacities (lb):</b>	100, 225, 325, 450, 550, 1000, 1500, 2000, 4500
<b>Rated Capacities (kg):</b>	50, 100, 150, 200, 250, 500, 750, 1000, 2000
Accuracy Class	C3
Maximum Verification Intervals ( <b>n</b> max)	3000
Minimum load cell verification interval (Vmin)	E <sub>max</sub> / 10,000
Combined Error	≤ ±0.02 % FS
Creep (30minutes)	≤ ± 0.016%FS
Temperature Effect on Sensitivity	≤ ± 0.011 %FS/10°C
Temperature Effect on Zero	≤ ± 0.015 % FS/10°C
Rated Output	2.0 ± 0.002 mv/v
Input Resistance	400 ± 20 Ω
Output Resistance	351 ± 2.0 Ω
Insulation Resistance	≥ 5000 MΩ (50VDC)
Zero Balance	1.50 % FS
Compensated Temperature Range	-10°C ~+ 40 °C
Operating Temperature Range	-35°C ~+ 70 °C
Recommended Excitation	05 ~ 12 V (DC)
Maximum Excitation	18 V (DC)
Safe Overload	150 % FS
Ultimate Overload	300 % FS
Corner Correction	0.02 % Load Value / 100mm
Applicable Platform Size For (100-450 lb / 50-200Kg)	15.80 x 15.80inchss / 400 x 400mm
Applicable Platform Size For (550-1000 lb / 250-500Kg)	23.70 x 31.60inchss / 600 x 800mm
Applicable Platform Size For (1500-45000 lb / 750-2000Kg)	47.38 x 47.38inches / 1200 x 1200mm

The technical data given here serve only as a product description and must not be interpreted as guaranteed characteristics in the legal sense.

# Model A295

## OUTLINE DIMENSIONS:

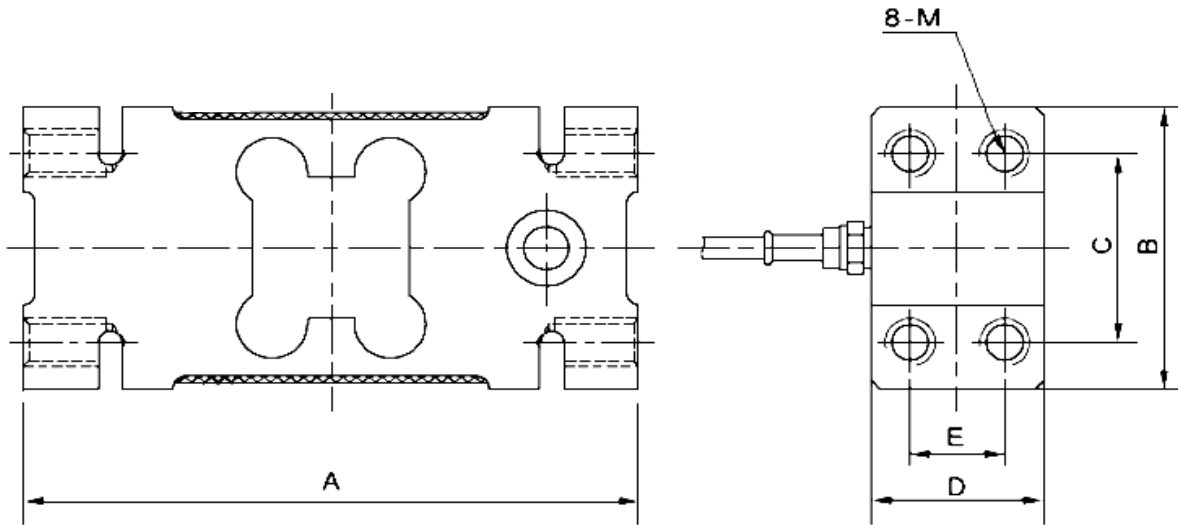

## DIMENSIONS:

Capacity	A	B	C	D	E	M
<b>lb/inches</b>						
100-450	6.16	4.93	3.75	3.00	1.81	M0.47X0.27
500-1000	5.76	3.75	2.76	2.36	1.42	M0.47X0.27
1500-4500	6.94	4.85	3.75	3.00	1.81	M0.63X0.27
<b>kg/mm</b>						
50-200	156.0	125.0	95.0	76.0	46.0	M12X7.0
250-500	146.0	95.0	70.0	60.0	36.0	M12X7.0
750-2000	176.0	123.0	95.0	76.0	46.0	M16X7.0

## WIRING

Function	Colors
+ Excitation	Red
- Excitation	Black
+ Signal	Green
- Signal	White
+ Sense	Brown
- Sense	Black

Correct Mounting of Load Cells Is Essential To Ensure Optimum Performance.

3193 N, Drinkwater Blvd, P.O.Box 32662, Scottsdale, AZ 85251, U.S.A

Phone: # 480-240-1299

Fax: # 480-240-1300

Email: Info@themaxtechnologies.com

Max Technologies reserves the right to make changes to the technology, features, specification and design of the equipment without notice.